

TLC^{EU}

SST

temporary spiral staircase

Stairs are used on construction sites to facilitate communication between different levels.

The system comprises a base frame, intermediate module, exit step, or exit landing.

The construction is protected by hot-dip galvanization and is designed according to PN EN 12811 standard.



modular construction
allowing the product
customization for your needs



Possibility of compilation
up to 8 modules
(18440 mm)

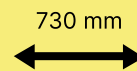

730 mm
usable widths of stairs
and landings – 730 mm



assembly based on
screw connections



anchoring stairs to
the structure using
stabilizing consoles



compliance with
the standard
PN-EN 12811

Acceptable load unfolded

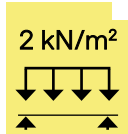

Acceptable load focused

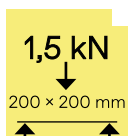

8 MODULES
18440 mm (max H)

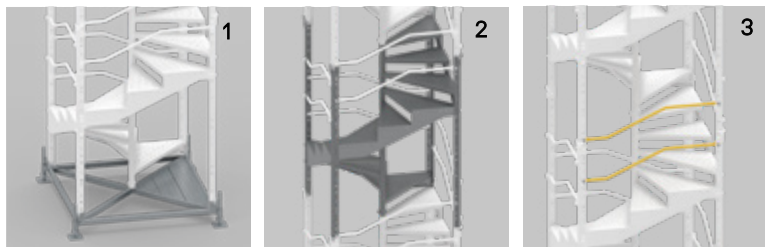
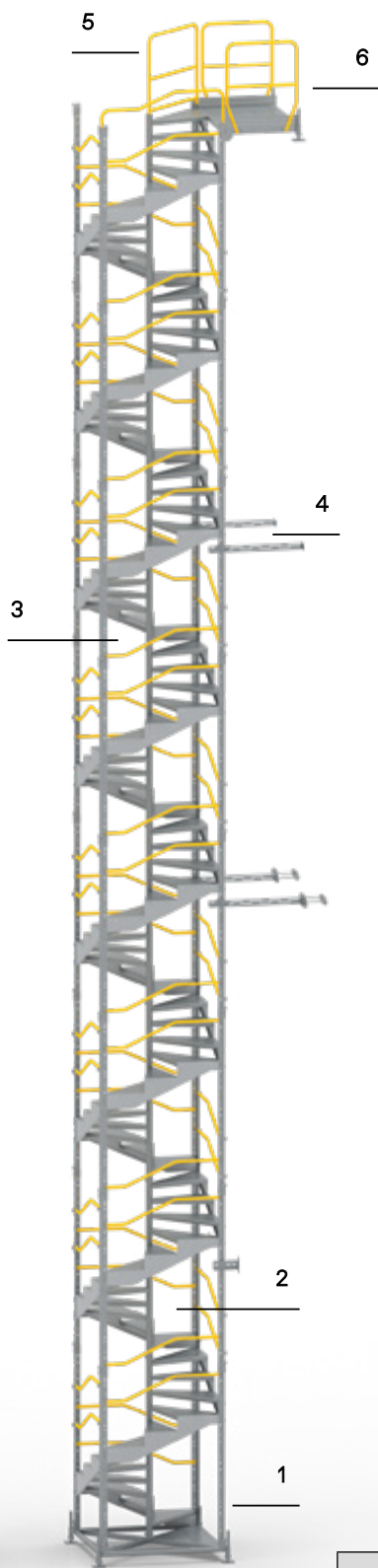

Base frame

Intermediate module
(H 2280 mm)

Barrier

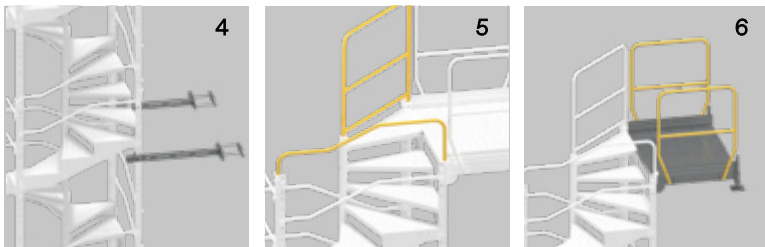

Stabilising consoles

Top module barrier

Exit landing

OPTIONAL SOLUTIONS

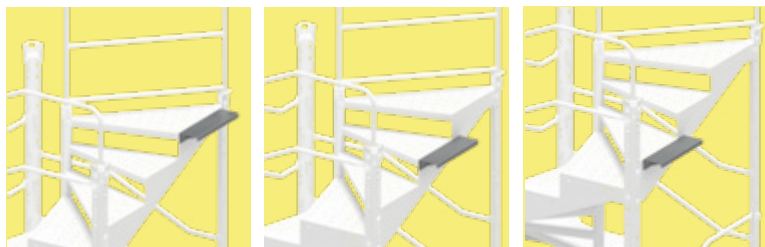

Exit step

Alternative options for mounting a exit step



Optional toe board

Optional assembly of another exit platforms



Additional level adjustment options for stair exit using TAS steps. Mounting of a platform without slab support with the possibility of lateral exit

Module	1	2	3	4	5	6	7	8
Height [mm]	2480	4760	7040	9320	11600	13880	16160	18440
Width [mm]	1600	1600	1600	1600	1600	1600	1600	1600
Weight [kg]	307	534	761	987	1214	1441	1667	1894